

Plain (Unreinforced) Residential Basement Wall

Foundation drain can also be located on the exterior side of the footing, or on both sides if necessary. The drain should be placed below the top of the footing.

Optional footing drain, such as 2 inch (51 mm) PVC pipe at 8 feet (2,400 mm) on center, allows water on the exterior to drain to the under-slab foundation drain. These can be cast into the footing or constructed using plastic pipes through the bottom of the first course of concrete masonry, directly on top of the footing.

Local codes may restrict the use of foam plastic insulation below grade in area where the hazard of termite damage is high.

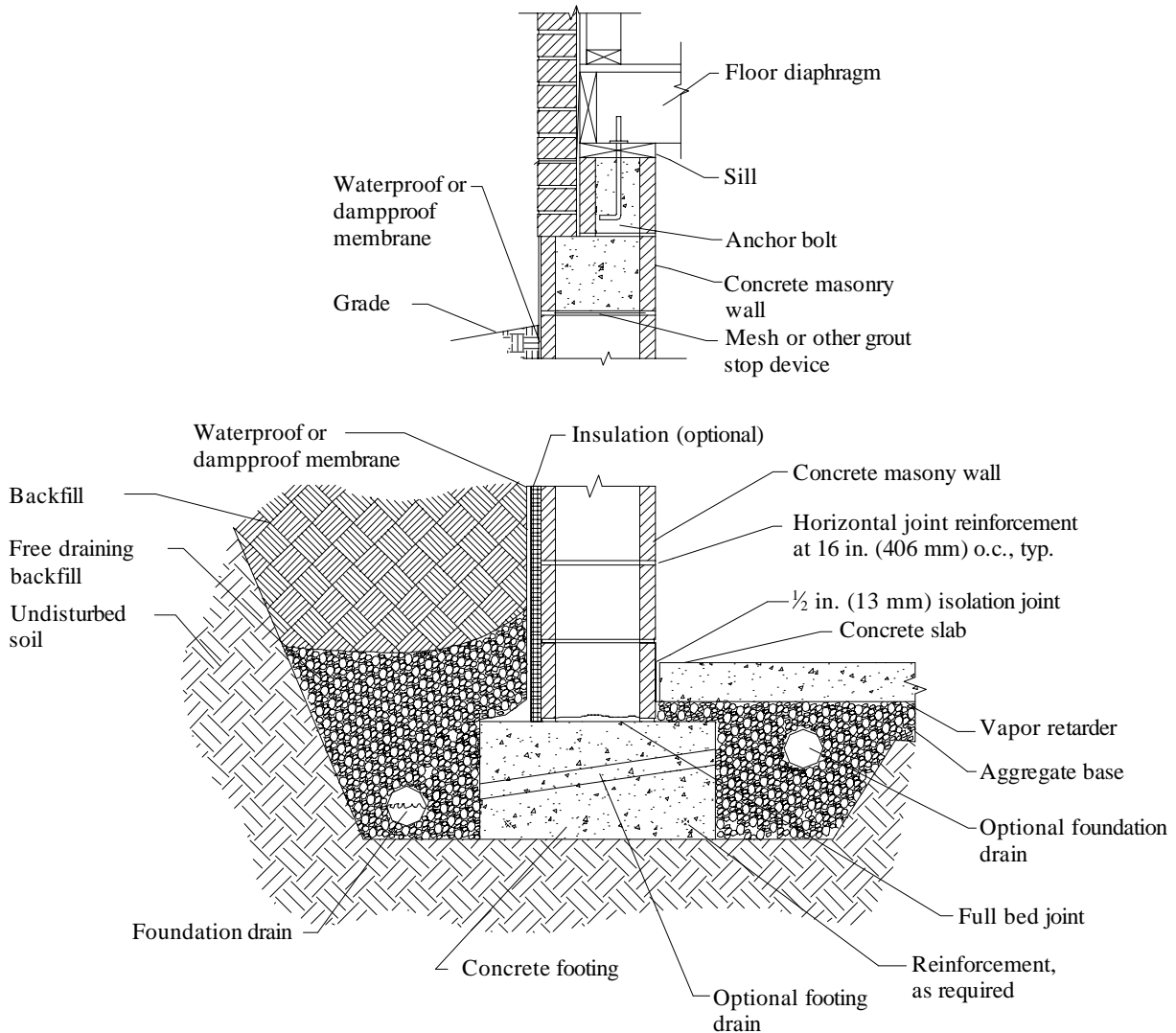

Last Modified: December, 2002